

WIRELESS PRODUCTS

Our range of wireless products are based on DIGI make XBEE 865 modules. Our Wireless Products will enable the user to provide all range of wireless applications with minimum time and effort.

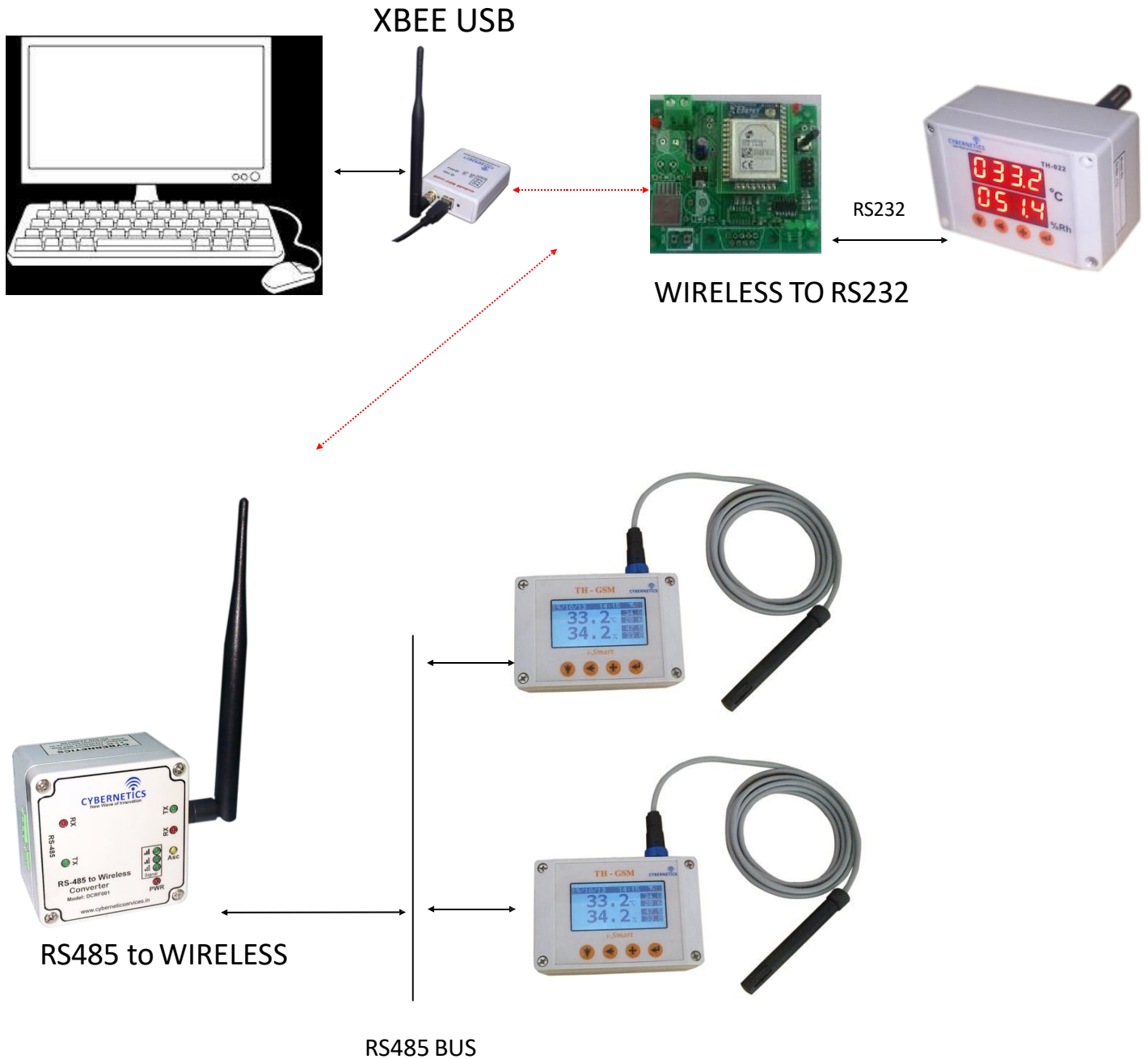

WIRELESS SPECIFICATIONS

	XBee® 865LP for India	Programmable XBee® 865LP for India
Hardware		
Processor	ADF7023 transceiver, Cortex-M3 EFM32G230 @ 32 MHz	
Frequency Band	865 MHz to 867 MHz	
Antenna Options	U.FL, RF Pad and PCB	
Performance		
RF Data Rate	10 Kbps or 80 Kbps	
Indoor/Urban Range	Up to 370 ft (112 m) w/2.1 dBi antenna, up to 46 ft (14 m) w/PCB embedded antenna	
Outdoor/Line-Of-Sight Range	Up to 5.2 miles (8.4 km) w/2.1 dBi antenna, up to 0.4 miles (.64 km) w/PCB embedded antenna	
Transmit Power	Up to 12 dBm (16 mW), software selectable	
Receiver Sensitivity	-101 dBm @ 80 Kbps, -106 dBm @ 10 Kb	

XBEE USB MODEM

Xbee USB modem has a Digi Make XBEE 865 module. It is used to transmit and receive data from computer to the other XBEE 865 modules wireless connect the wireless modules in the field. When drivers are installed in the computer an extra com port is visible through which data can be received and transmitted.

FEATURES

- 1) Operating Frequency of 865MHz
- 2) Data rate over the air of 10/80 Kbps
- 3) FTDI chip based on USB side
- 4) USB powered and with cable length of 1 meter
- 5) Data Transmit and Receive Led Indications on both USB side and wireless side
- 6) Adds Virtual COM port in computer when drivers are installed
- 7) Signal Strength indications

APPLICATIONS

- 1) Wireless Sensor Network
- 2) Signal testing and Signal Range test in the field



WIRELESS TO RS485

RS485 to wireless converter is the direct replacement to the long length and high maintenance requirements of RS485 bus in the Industries. These modules are easy to install and plug and pay devices thus avoiding.



FEATURES:

- 1) Operating frequency 865 MHz
- 2) 19200 Baudrate on RS485 side
- 3) Transmit and Receive LED indications on RS485 side and wireless side
- 4) 12—24V operating voltage
- 5) In built ESD protection for RS485 bus
- 6) Signal Strength indication

APPLICATIONS

- 1) Wireless Sensor Network
- 2) Industrial Instrumentation for data communication

WIRELESS TO RS232 CONVERTER

Wireless to RS232 converter is the direct replacement to the RS232 cable between two instruments



FEATURES:

- 1) Operating frequency 865 MHz
- 2) Configurable Baudrate on RS232 side
- 3) Transmit and Receive LED indications on RS485 side and wireless side
- 4) 5V or Optional 12—24V operating voltage
- 5) Signal Strength indication
- 6) Configuration can be done with the help of X-CTU software and USB to TTL converter cable (Please refer data converter product)